

How it works

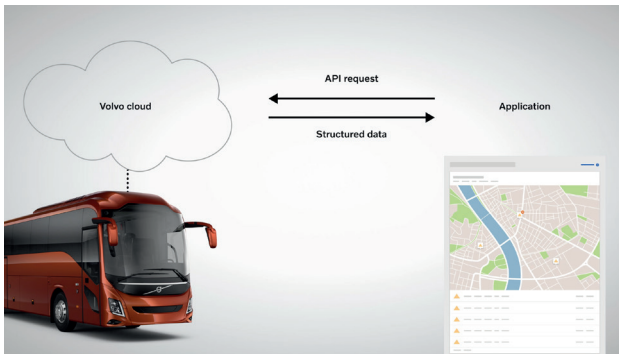

APIs are used by developers to enable computer programs to communicate with each other over the internet. A computer system can use a line of code to

send a request to the API, for instance, to get the GPS position of a specific bus. The API will then respond with a set of data to be used by the receiving system.

Developer portal

Volvo Buses encourages and supports customers and thirdparty suppliers to develop services using Volvo vehicle data. The way to do this is described in our developer portal, where you can also access various tools and explore more of the possibilities with fleet management connectivity from Volvo. In the Developer portal, you find all guides, instructions and technical documentation for the Connect APIs.

<https://developer.volvobuses.com/>

The APIs

Connect API comes in three different versions. Diesel, Electric and a dedicated version for energy storage data.



Diesel

Access to information about the diesel buses in a fleet, their positions and operational data.

Vehicle details

VIN, production date, country of operation, etc.

Fuel data

Fuel consumption, remaining distance, etc.

Driving data

Ambient temp, time driving, vehicle speed, odometer, etc.



Electric

Access to information about the electric buses in a fleet, their positions and operational data.

Vehicle details

VIN, production date, country of operation, etc.

Charging data

Charging status, charging power, time to fully charged, etc.

Energy data

SOC, energy consumption, remaining range, etc.

Driving data

Ambient temp, time driving, vehicle speed, odometer, etc.



ESS power

Sampled instant power data from the Energy Storage System (ESS) installed within the vehicle.

Power data

Incoming and outgoing power values (throughput) in the ESS battery pack. 20 to 120 power values per report and minute.

Please contact your Volvo representative for more information.

volvobuses.com